

Closer To The **ACTION**

UNMISSABLE ACTION FROM A GREAT VANTAGE POINT

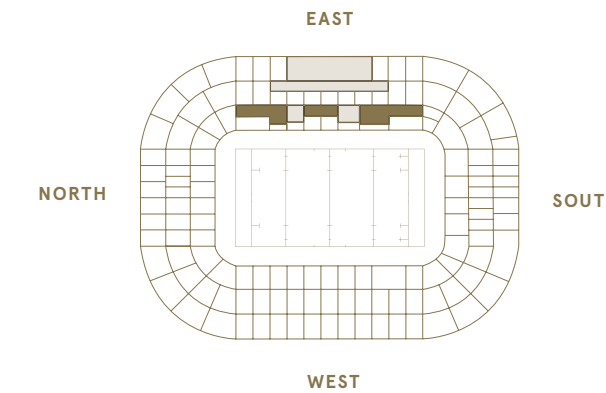
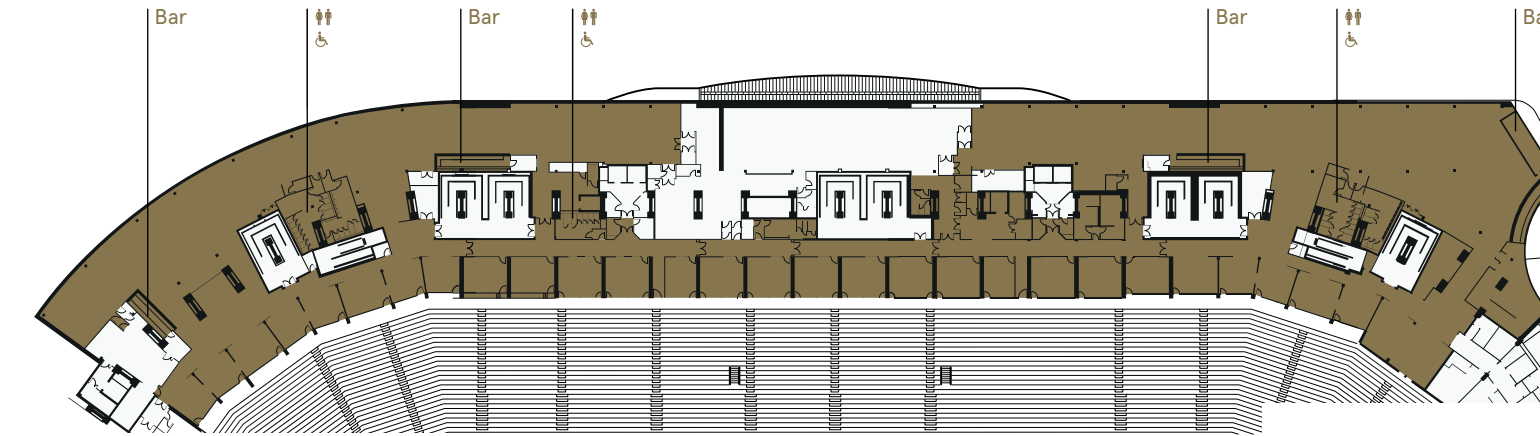

Allocated seating

Always **OFFICIAL**

THE FUTURE OF ENGLAND RUGBY HOSPITALITY

As the England team runs out onto Twickenham's hallowed turf for the first match in the 2018 Old Mutual Wealth Series, a major transformation will already have kicked off at the Home of England Rugby.

The magnificent new East Stand will be buzzing and all official match day hospitality will be sold and delivered exclusively inside the stadium by England Rugby Hospitality sales specialists supported by long standing partner Keith Prowse.

With seven fabulous facilities, four of which are brand new and exclusive to the redeveloped East Stand, Twickenham match days will combine the ultimate hospitality experience with the hottest tickets in town

The best in modern hospitality will unite with the history and heritage of the stadium and celebrate the sport's values.

To find out more or book your experience please visit online at:

ENGLANDRUGBYHOSPITALITY.COM



THE LOCK

PASSION IS KEY

Exclusive EXPERIENCE

BINDING A CELEBRATION OF ENGLAND RUGBY WITH A GREAT PITCH VIEW

The engine room of the scrum and the target player in the lineout, the lock is an essential part of the team on the pitch and The Lock restaurant delivers similar exclusive qualities off it.

The Lock opens three and a half hours before kick-off allowing you to avoid the crowds as you arrive through your dedicated entrance to enjoy traditional, formal hospitality with a contemporary twist. Private tables of between two and ten people are available, where classic English inspired menus, combined with tastes from the opposing nation, will be served. Whether it's incredible Argentine steaks or succulent New Zealand lamb, the food will bring all the match-day flavour.

From floor to ceiling The Lock radiates all things England Rugby, with two distinct rugby bars, offering a comprehensive drinks selection and experienced mixologists crafting cocktails galore. Once you have eaten and toasted your friends and the team, you can take your stadium seat which is perfectly positioned with the majority being in the 22s, offering a great vantage point to take in every second of the action.

Once the final whistle has gone, return to The Lock and talk through the day's play, alongside rugby legends and heroes of the game.



View from seat

Dramatic VIEWS

PACKAGE INCLUSIONS

- Four course plated menu.
- Classic dishes with a contemporary twist.
- Full bar including Champagne, premium spirits, fine wines and bespoke cocktails.
- Food and drink paired to the opposition.
- East Stand, lower tier tickets, majority within the 22s.
- Half time drinks served in the restaurant.
- Rugby hosts to socialise.
- Post-match Twickenham Tea

KEY ATTRIBUTES

- Private VIP lobby.
- Pitch facing, dual aspect restaurant.
- Private tables of two+.
- England Rugby themed.
- Semi-private areas.
- Banquette seating.
- Direct suite-to-seat access.
- Bar area with TVs.
- Facility opens 3.5 hours pre-match and 1.5 hours post-match.
- Hostess staff on hand to ensure that your day runs smoothly.

