

Closer To The ACTION

INFORMAL AMBIENCE AND ELECTRIC ATMOSPHERE

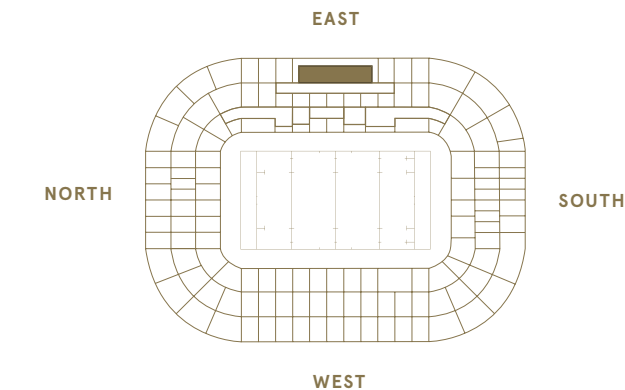
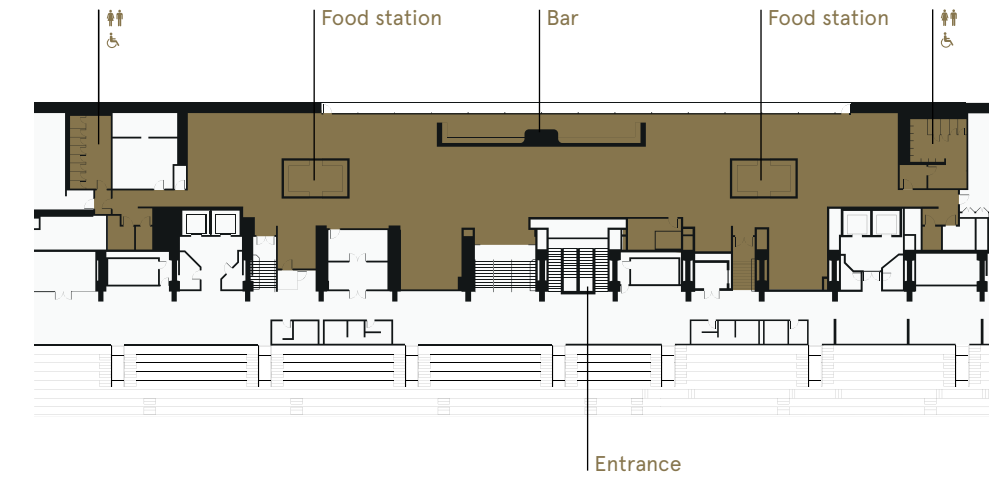

Allocated seating

Always OFFICIAL

THE FUTURE OF ENGLAND RUGBY HOSPITALITY

As the England team runs out onto Twickenham's hallowed turf for the first match in the 2018 Old Mutual Wealth Series, a major transformation will already have kicked off at the Home of England Rugby.

The magnificent new East Stand will be buzzing and all official match day hospitality will be sold and delivered exclusively inside the stadium by England Rugby Hospitality sales specialists supported by long standing partner Keith Prowse.

With seven fabulous facilities, four of which are brand new and exclusive to the redeveloped East Stand, Twickenham match days will combine the ultimate hospitality experience with the hottest tickets in town

The best in modern hospitality will unite with the history and heritage of the stadium and celebrate the sport's values.

To find out more or book your experience please visit online at:

ENGLANDRUGBYHOSPITALITY.COM



THE
ROSE GARDEN
WHERE EXCITEMENT GROWS

Ultimate ATMOSPHERE

THE BEST RUGBY PARTY. INFORMAL, VIBRANT AND FUN!

Welcome to The Rose Garden.

Located on level five of Twickenham Stadium, with easy access from the main entrance, the Rose Garden ambience will be informal and the atmosphere, electric.

Opening three hours pre-match and offering live music, hand-held street food and a range of complimentary drinks, including real ales and draught Guinness, and match seats in the upper-tier within the 22s which provide a cracking view of all of the sporting action.

Continue to enjoy the hospitality on offer at half time. Post-match snacks are served in The Rose Garden for up to an hour after the final whistle, giving you and your guests time to compare the team's performance with like-minded rugby fans while the crowds disperse.



View from seat

Live MUSIC

PACKAGE INCLUSIONS

- Street food, all day grazing.
- Full bar including real ale, Guinness and wine.
- Live music.
- Half time drinks served from the bar.
- East Stand, upper tier tickets within the 22s.

KEY ATTRIBUTES

- Informal space with unreserved seating.
- Rooftop vista.
- Large TVs; avoid missing any of the sporting action.
- Indoor/outdoor space.
- Facility opens 3 hours pre-match and one hour post-match.

